

# ToupTek Astro

## AAF (Astro Automatic Focuser) Quick Start

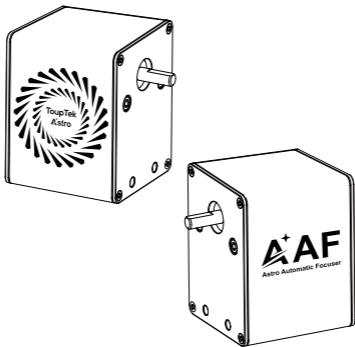

Thank you for purchasing the AAF(Astro Automatic Focuser). This document provides an overview of its key features and usage instructions. For more details, visit our official website at

***<https://www.touptek-astro.com>***.

For any issues, please contact us via email or your purchase channel.

## Product Introduction

The astronomical electric focuser is one of the essential accessories for astrophotography and observation. It precisely adjusts the position of the telescope's focuser with automated operation, ensuring accuracy and efficiency in astrophotography and observation.

The ToupTek Astro AAF ( Astro Automatic Focuser ) is plug-and-play, significantly enhancing the efficiency and precision of astrophotography and observation. It supports the focusing needs of most telescopes on the market and adapts to various environmental conditions.

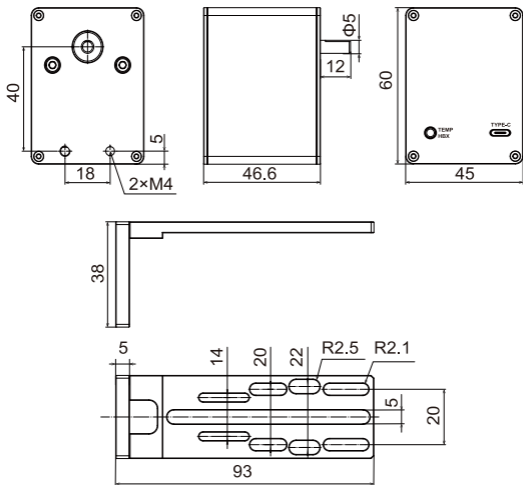

AAF ( Accessory ) Dimensions and Interface Description

## Packaging Accessories



AAF Body

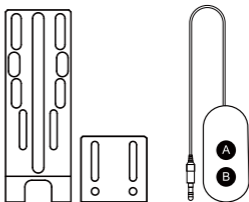

Standard Connection Plate Handle



Flexible Coupler×4  
(Outer Diameter 19mm / Length 25mm)  
(5-4mm/5-5mm/5-6mm/5-7mm)



M3 Screws×2  
M5 Screws×2

M4 Screws×4  
Washers×4

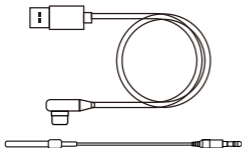

TYPE-C Data Cable(1m)  
Temperature Sensing Cable(0.1m)



M2.5 / M3 / M4 / M5 Hex Wrench (1 each)

## Installation Instructions



1. Check the packing list and use M3 screws to assemble the standard connection plate.



2. Remove the focusing knob from the telescope.



3. Select and install the appropriately sized flexible coupler.



4. Use M4/M5 screws to mount the AAF body onto the flexible coupler.



5. Install the standard connection plate on the focuser base, secure it with M4 screws to attach it firmly to the AAF and ensure stability.



6. According to specific usage requirements, connect the USB data cable / temperature sensing cable / handle.

# After-sales Service Policy

## 1. Standard Warranty

Warranty Period: From the date of purchase and receipt by the customer from our company, we provide a free warranty service for a period of 2 years. For AstroStation products, the warranty period starts from the date the customer's device is successfully activated.

## 2. Dead on Arrival (DOA) Handling

In the event of a DOA situation, please contact ToupTek within the specified time limit and provide the purchase invoice and relevant proof. ToupTek will arrange for doorstep pickup service and take the following actions based on specific circumstances:

① Replacement for Quality Issues: Within 90 days of receipt, if the product is confirmed to have quality issues by ToupTek Customer Service Center, the company will replace it with a new one free of charge. ② Handling of Transportation Damage: Within 7 days of receipt, if the product's external packaging shows obvious signs of water stains, severe crushing, or other transportation damage, the user needs to submit photos of the external packaging and proof of receipt. After verification that it was caused by direct transportation by ToupTek or an authorized distributor, the company will provide return or exchange services. If sold or transported directly by a distributor, the distributor will handle the matter.

## 3. Non-Warranty Service Scope and Repair Policy

The following situations are not covered under warranty, and ToupTek may provide paid repair services:

Products beyond the warranty period; product damage due to water ingress, moisture, or corrosion; damage caused by external forces (such as scratches, deformation of the shell, USB interface breakage, etc.); unauthorized disassembly, third-party repairs, modifications, or firmware flashing without written authorization from ToupTek; unauthorized alteration or loss of warranty labels; quality issues caused by failure to follow product instructions; physical damage due to force majeure (such as natural disasters); damage due to improper user operation; inability to provide valid purchase invoices and warranty certificates or purchase of second-hand products.

## 4. Replacement Policy for Accessories

If accessories or other parts provided with the product have quality issues, users can request replacement of new accessories separately. This does not affect the main unit's return and exchange conditions.

This guide may be updated without prior notice.

You can find the latest version of the "User Manual" on the **ToupTek Astro** official website.

If you have any questions or suggestions, please contact us via the following email:

***marketing@touptek.com***

Subscribe "**ToupTek Astro**" for more information



Facebook@ToupTek Astronomy Cameras



Cloudy Nights@ToupTek Astro



Instagram@touptekastro



YouTube@ToupTek Astro



Astrobin@ToupTek Astro



marketing@touptek.com



www.touptekastro.com



13F,14F,15F, Aoqiang Building 1, No.6, Xiyuan 5th Rd.,Hangzhou, 310030, Zhejiang, P.R.China

**ToupTek Astro**

Copyright © ToupTek Astro All Rights Reserved.